

OWNER'S CERTIFICATION

I do hereby certify that I am the owner of record of the property shown hereon, and do hereby adopt this survey.

OWNER _____ DATE _____

CERTIFICATE OF ACKNOWLEDGEMENT I certify that I am a notary for the state-at-large. I further certify that the above owner signature(s) are legal and have been executed voluntarily, to the best of my knowledge and belief.

Notary Public _____ Date _____

Date Commission Expires _____

GPS NOTE: The survey shown hereon is based on GPS data collected by Miller, Tungate Land Surveying, LLC. using both Static and RTK methods with dual frequency Carlson BR6+ and BRX7 receivers. Data was also collected using conventional EDM equipment. The Kentucky Single Zone Coordinate, NAD 83 was used for coordinate system. Acceptable positional tolerances were achieved by redundant measurements on all GPS control points.

SPECIAL SURVEYOR NOTE: Surveyor talked to Phillip Moss & James R. Graham and they stated the fence has always been the division between properties.

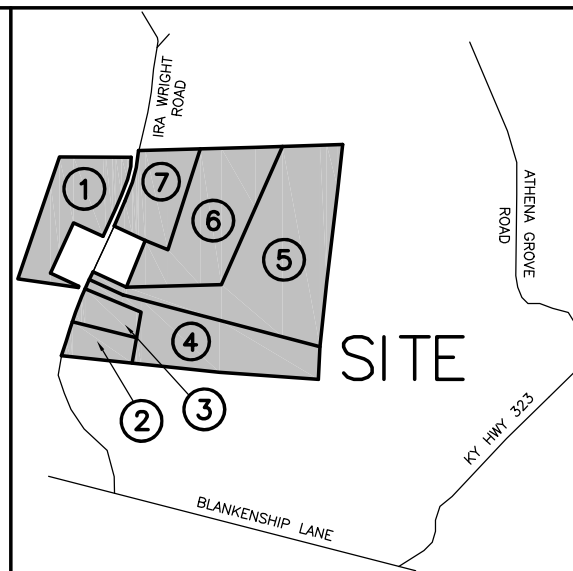
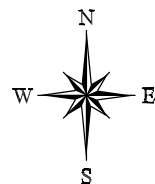

NOTES:

- 1 - The property shown on this plat is subject to all right-of-ways and easements whether implied or of record.
2 - There is some fencing around the perimeter of this property. The boundary lines follow the general course of the fence in some places. In other places the fence may be on one side of the boundary or the other.
3 - Ira Wright Road is being given a 40' right of way per this division. Right of way varies per other surveys found in the area.
4 - There were no visible cemeteries, nor were we made aware of any existing cemeteries.
5 - Easement for Ingress and Egress for Tract 5 & Tract 6. Said Easement can be used for utilities as long as it does not restrict the flow of Ingress & Egress.
6 - The property owners on the opposite side of road(s) shown hereon are taken from the Property Valuation Office.

TOTAL ACRES FOR TRACT 1 = 8.11 ACRES TRACTS 2, 3, 4, 5, 6, & 7 54.54 ACRES

LINE TABLE

Table with 3 columns: LINE, BEARING, DISTANCE. Lists lines L1 through L20 with their respective bearings and distances.

LEGEND

- Iron Pin and Cap (1/2 inch rebar 18 inches long, with yellow cap marked TUNGATE PLS 3997) set this survey unless otherwise noted.
Unmarked point.
Existing Iron Pin (1/2" rebar) No Identification Cap.
Iron Pin, set as Witness (1/2 inch rebar 18 inches long, with blue cap marked WITNESS PT, PLS 3997)
Corner is specified monument, located by bearing and distance from iron pin and cap Existing (Stamped G. Bills 4365)
Existing 1/2" Iron Pin and Cap G.BILLS-4365 "BILLS" E.L. COX "COX" TUNGATE "TUN"
"FOUND" Monument called out in a recorded document.
Existing Fence

AUCTION EXHIBIT NOT TO SCALE PRELIMINARY PLAT NOT FOR RECORDING OR LAND TRANSFER ALL DISTANCES AND ACREAGES ARE APPROXIMATE

CERTIFICATION

I hereby certify that the survey depicted by this plat was done by persons under my direct supervision by the method of random traverse with sideshots and is true and correct to the best of my knowledge and belief. The unadjusted precision ratio of the traverse was 1:19,463 and was adjusted. The survey as shown hereon is Rural class survey and the accuracy and precision of said survey meets all specifications of this class.

Gregory H. Tungate, Surveyor Kentucky PLS #3997 DATE _____

Surveyor's Note: This survey does not constitute a title search by this surveyor and as a result the undersigned is not responsible for the investigation or independent search for easements, appurtenant easements or any other facts that an accurate and current title search may disclose.

KRS NOTE:

178.025 Road presumed established - Presumption of width and area of public road right-of-way.

- 1. Any road, street, highway, or parcel of ground, dedicated and laid-off as a public way and used without restrictions on a continuous basis by the general public for fifteen (15) consecutive years, shall conclusively be presumed to be a public road.
2. In the absence of any record, the width of a public road right-of-way shall be presumed to extend to and include that area lying outside the shoulders and ditch lines and within any landmarks such as fences, fence posts, cornerstones, or other similar monuments indicating the boundary lines.
3. In the absence of both record or landmark, the right-of-way of a public road shall be deemed to extend to and include the shoulders and ditch lines adjacent to said roadway to the top of cuts or toe of fills where such exist.

Effective: July 12, 2006 History: Amended 2006 Ky. Acts ch. 236, sec. 1, effective July 12, 2006. - Amended 2004 Ky. Acts ch. 61, sec. 2, effective July 13, 2004. - Created 1966 Ky. Acts ch. 108, secs. 1 to 3.

SURVEY OF THE JAMIE WRIGHT LAND DIVISION APRIL, 2026

Property information block including Owner/Client (JAMIE M WRIGHT), Property Location (IRA WRIGHT ROAD, SUMMERSVILLE, KENTUCKY), Source of Title (JAMIE M. WRIGHT TRACT 1,2,3,4,5,6,7), Part of (DEED BOOK 211, PAGE 228), Scale (1 INCH = 150 FEET), and Survey Completion Date (APRIL 9, 2026).

Miller, Tungate Land Surveying logo and contact information: 202 Brookside Ave., Campbellsville, KY 42718, (270) 465-2831.